



HH492

Cordless Area-Imaging Scanner and Charge Base

Quick Start Guide

Agency Model: HH492, B100-492

Note: *Refer to your User Guide for information about cleaning your device.*

Getting Started

Turn off computer's power before connecting the scanner or base, then power up the computer once the scanner or base is fully connected. The green LED will illuminate continuously on and indicates the base is ready.

Connecting with USB

Note: *If you are charging the scanner using the cable the current available for charging is reduced and charge times are increased.*

Base:

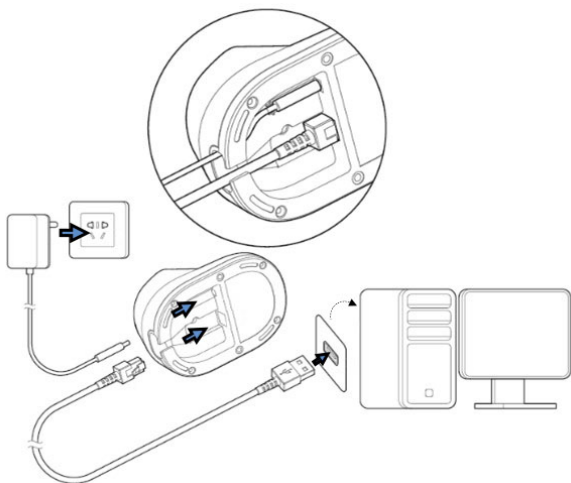

Cable and Dongle:

Note: When a scanner is connected to the cable, the battery will charge. The cable will not facilitate communication with the host system or other scanners.

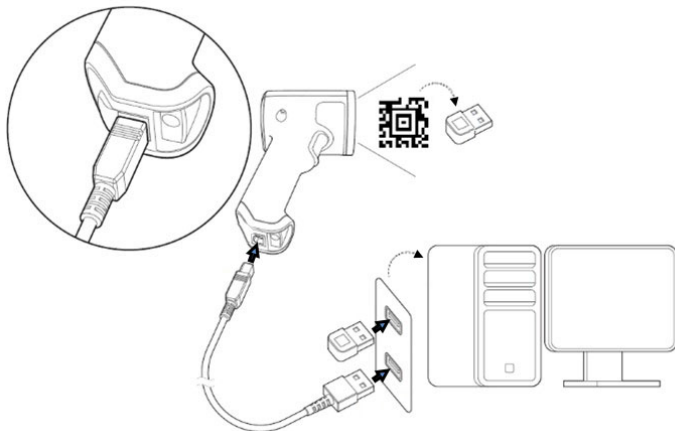

Reading Techniques

The view finder projects an aiming dot that should be centered over the barcode, but it can be positioned in any direction for a good read.

Hold the scanner over the barcode, pull the trigger, and center the aiming dot on the barcode.

The aiming dot is smaller when the scanner is closer to the code and larger when it is farther from the code. Hold the scanner close to smaller barcodes, and farther away from large barcodes to get a proper read.

If the barcode is highly reflective (e.g., laminated), you may need to tilt the scanner at an angle so the barcode can be scanned.

Note: *If the scanner razzes when scanning a barcode, the link has not been established. If the scanner beeps once, the link has been established.*



Standard Product Defaults

The following barcode resets all standard product defaults settings.



Standard Product Defaults

Link the Scanner

Scan the MAC address barcode on the bottom of the base or on the dongle to establish a connection. The scanner emits two beeps to confirm a connection.

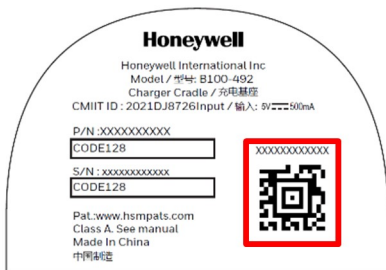

Unlink the Scanner

If the base or dongle has a scanner linked to it, that scanner must be unlinked before a new scanner can be linked. Once the previous scanner is unlinked, it will no longer communicate with the base or dongle. Scan the **Unlink Scanner** barcode to unlink a scanner.



Unlink Scanner

USB HID Interface

Scan the following code to program the scanner for USB HID.



USB HID

Charge the Scanner

If the scanner is connected to the base, charge time is approximately 4 hours.

If the scanner is not connected to the base or charging through the USB cable, charge time is approximately 9 hours.

Trigger

The following barcodes will allow you to use the scanner in **Manual Trigger - Normal Mode** (need to press the trigger to read) or **Presentation mode** (the scanner is activated when it “sees” a barcode).



Manual Trigger - Normal
(Default)



Presentation Mode

Suffix

If you want a carriage return after the barcode, scan the **Add CR Suffix** barcode. To add a tab after the barcode, scan the **Add Tab Suffix** barcode. Otherwise, scan the **Remove Suffix** barcode to remove the suffixes.



Add CR Suffix



Add Tab Suffix



Remove Suffix

Support

To search our knowledge base for a solution or to log into the Technical Support portal and report a problem, go to honeywell.com/PSStechnicalsupport.

User Documentation

For the user guide and other documentation, go to sps.honeywell.com.

Limited Warranty

For warranty information, go to sps.honeywell.com and select **Support > Warranties**.

Patents

For patent information, see www.hsmpats.com.

Disclaimer

Honeywell International Inc. (“HII”) reserves the right to make changes in specifications and other information contained in this document without prior notice, and the reader should in all cases consult HII to determine whether any such changes have been made. HII makes no representation or warranties regarding the information provided in this publication.

HII shall not be liable for technical or editorial errors or omissions contained herein; nor for incidental or consequential damages resulting from the furnishing, performance, or use of this material. HII disclaims all responsibility for the selection and use of software and/or hardware to achieve intended results.

This document contains proprietary information that is protected by copyright. All rights are reserved. No part of this document may be photocopied, reproduced, or translated into another language without the prior written consent of HII.

Copyright © 2023 Honeywell Group of Companies. All rights reserved.